

# STONBROOK STONBROOK OFFICE ROCKY MOUNT, NC

DATE: OCT. 16, 2015  
 DRAWN BY: STL  
 PROJECT NO.: ZYY-1542  
 SHEET TITLE: PLUMBING OVERALL PLAN

SHEET: P1.1  
 2 OF 4

- | GENERAL NOTES - THIS SHEET |  |
|----------------------------|--|
| 1.                         | NEW OR RELOCATED ITEMS ARE SHOWN IN BOLD. SEE LEGEND.                          |
| 2.                         | P.C. TO VERIFY THAT NO FIXTURES ARE CONNECTED UPSTREAM OF BACK FLOW PREVENTER. |
- 
- | TAGGED NOTES - THIS SHEET |   |
|---------------------------|---|
| 1                         | 4" WASTE FROM FIXTURES: SEE ENLARGEMENT FOR CONTINUATION.   |
| 2                         | 1" CW UP FROM BELOW SLAB IN WALL: PROVIDE W/ BULL & ACCESS PANEL. SEE ENLARGEMENT FOR CONTINUATION. |
| 3                         | CLEARLY LABEL ALL PORTIONS OF CW LINE UPSTREAM OF BP "DO NOT TAP".                                  |

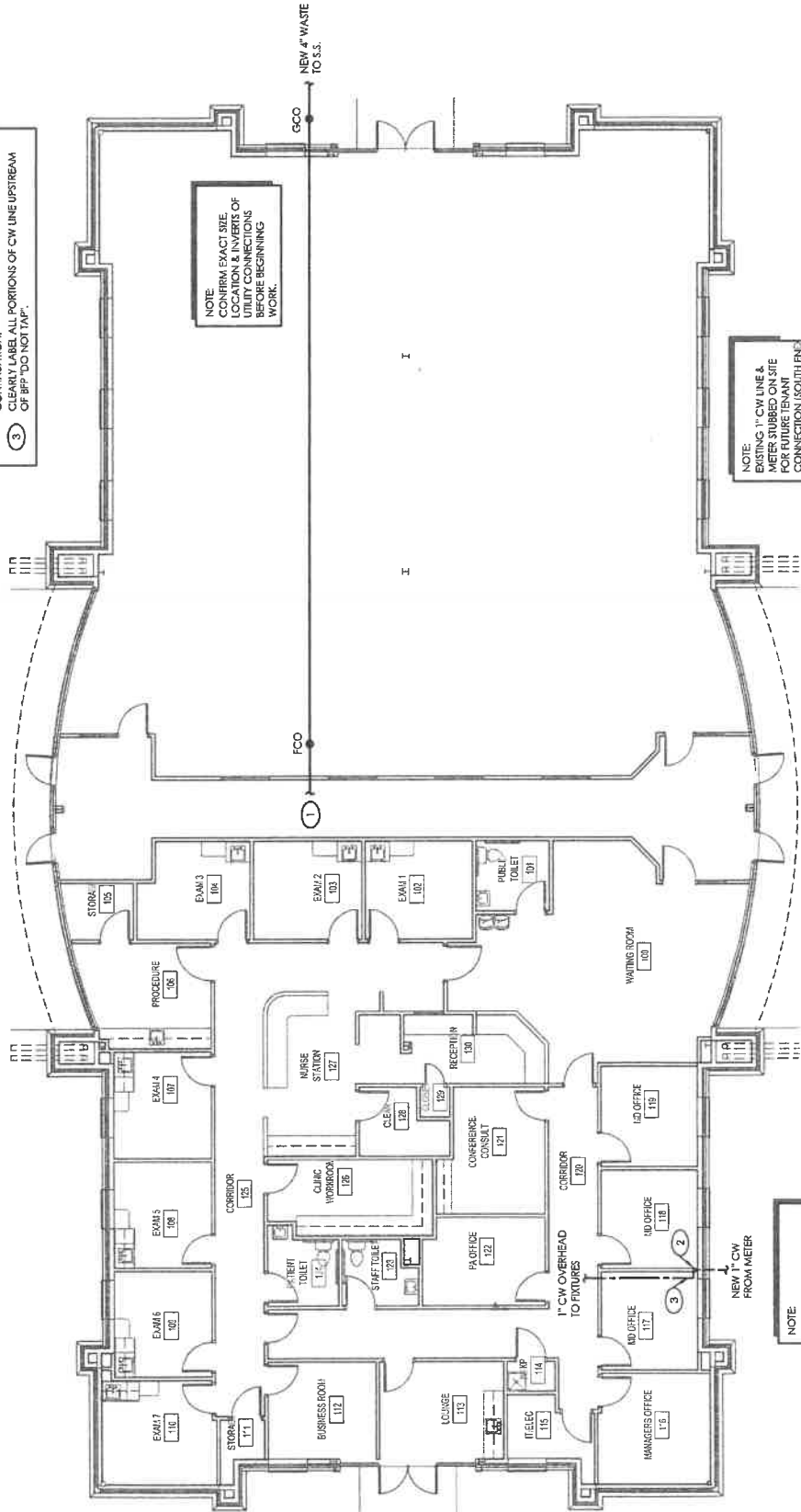

1 PLUMBING PLAN - OVERALL  
 SCALE: 1/8" = 1'-0"

NOTE:  
 CONFIRM EXACT SIZE,  
 LOCATION & INVERTS OF  
 UTILITY CONNECTIONS  
 BEFORE BEGINNING  
 WORK.

NOTE:  
 CONFIRM EXACT SIZE,  
 LOCATION & INVERTS OF  
 UTILITY CONNECTIONS  
 BEFORE BEGINNING  
 WORK.

NOTE:  
 EXISTING 1" CW LINE &  
 PAPER STUBBED ON SITE  
 FOR FUTURE  
 CONNECTION (SOUTH END  
 OF BUILDING).

